



OUR RANGES



S-LINE
Coupé

Space & open
26-29 kts

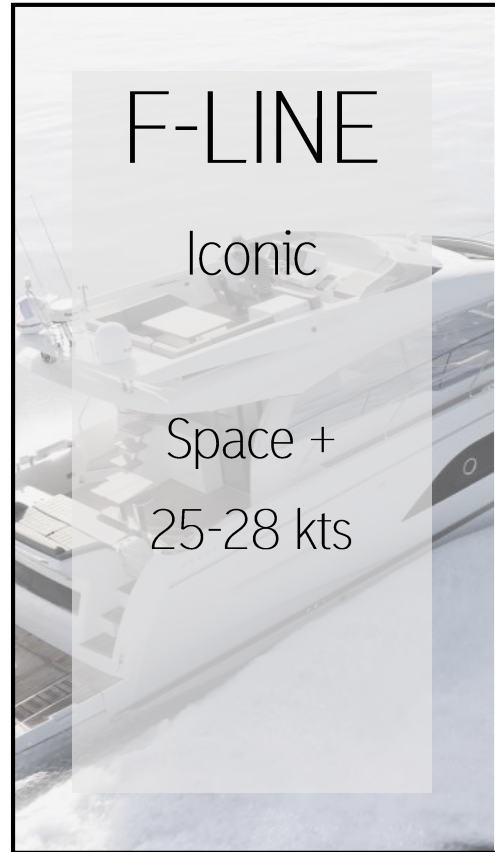

F-LINE
Iconic

Space +
25-28 kts



X-LINE
Crossover

Space ++
20-24 kts



M-LINE
XXL

Limitless space
8-20 kts

Introduction

M-Line



Unique Selling Points

PRESTIGE M-Line

Outstanding space for total relaxing and entertainment onboard

Catamarans advantage of wide space, natural light and multiple relaxing areas

High efficiency +20% vs monohulls

Lower emissions, lower operating cost

Stability of the catamaran, and a limited beam

Better seakeeping, less motion sickness, easier marina berthing, cost & weight optimized





1

OUTSTANDING SPACE

PRESTIGE

New dimensions in comfort on the water

- New hull base optimizing space onboard
- 130m² / 1400 sqft of living space on the M48

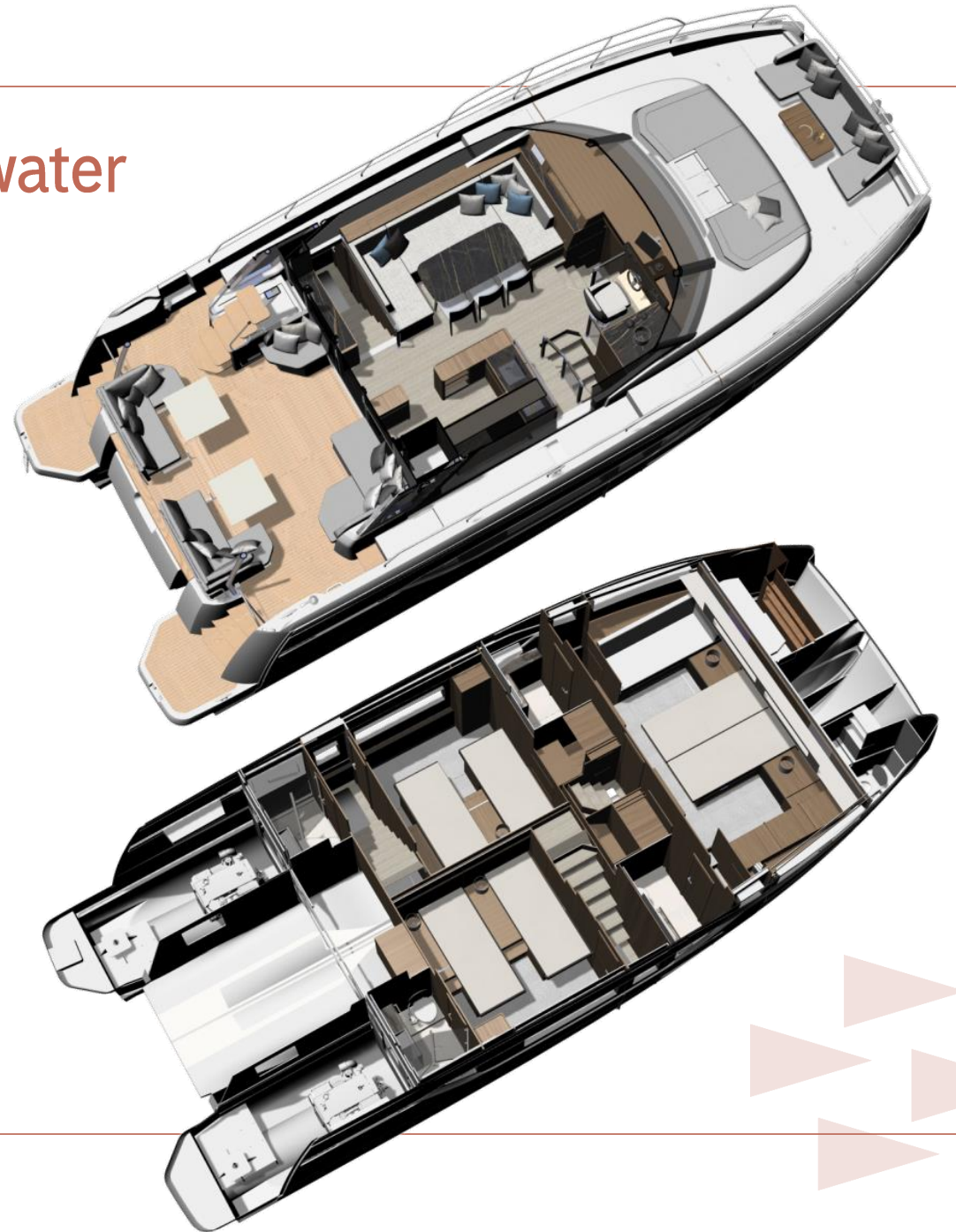



HIGH EFFICIENCY

2

PRESTIGE

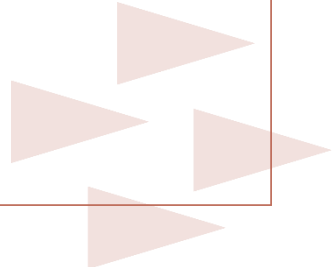

Lower emissions, lower operating cost

- 20 knots top speed
 - 80 liters per hour at 17 knots!
 - 600NM range at 8 knots!
 - M48 offers the benefit to the owners **to choose their cruising speed**
- 



STABILITY

PRESTIGE

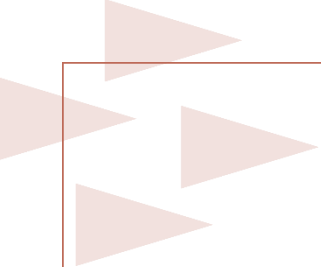
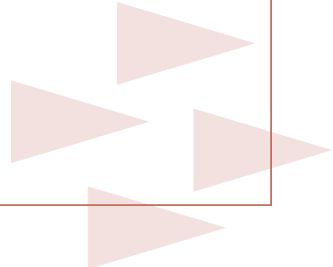
- 
- The architecture of the catamaran provides **natural stability at the anchor**
 - The twin hulls also provide **stability when underway**. No unsafe heeling, the boat remains steady
 - Our M-line beams are below market average for catamarans
- 

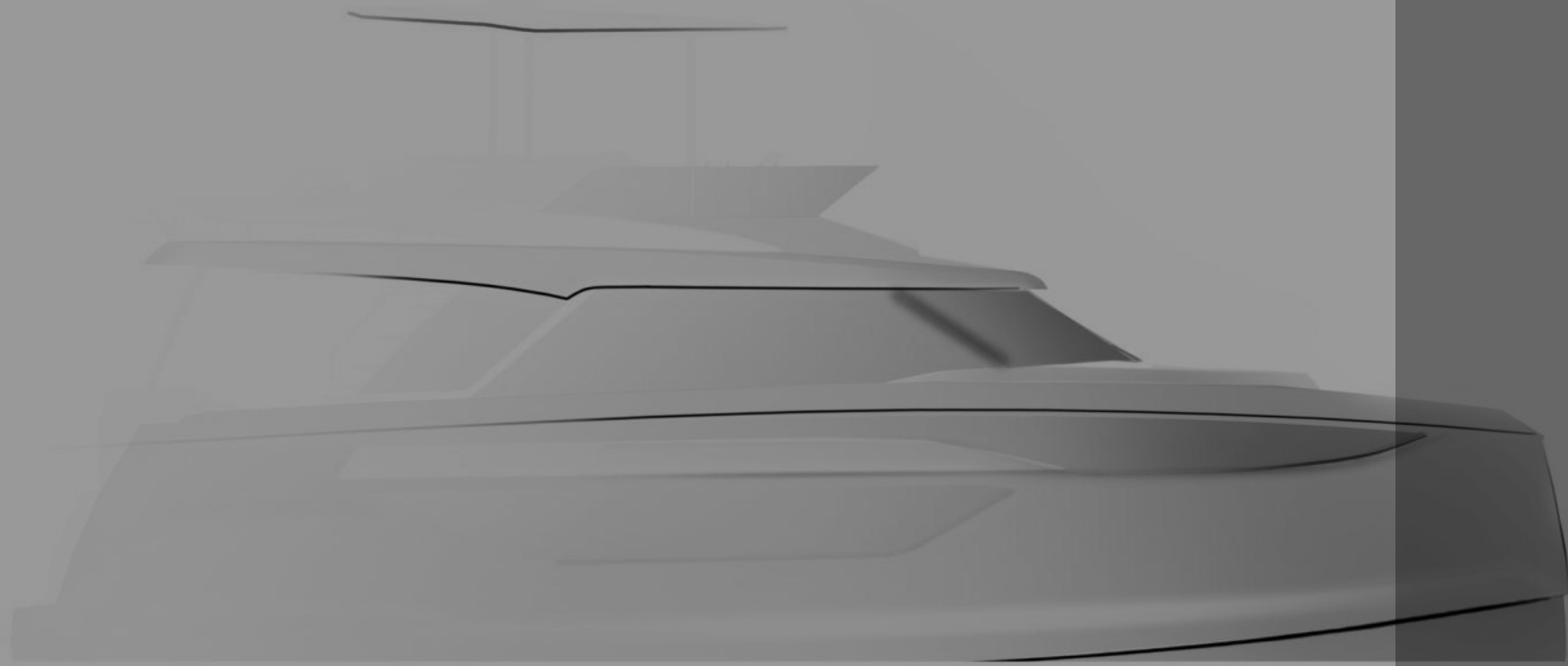

M48

Garroni Design

M48



M48



M48



M48

Hull length	14,05 m 46'1"
LOA	14,79 m 48'6"
Beam	6,00 m 19'8"
Engine	V-Drive Volvo 2x D4 320 hp Joystick
Max speed Cruising speed	20 kts 15 kts – 5 L/NM 8 kts – 2L/NM
Range	250 NM @ 15kts 600 NM @ 8kts
Fuel	1 200 L 317 US gal
Water	600 L 159 US gal
Air draft	Mini: 4,80 m / 15'9" Maxi: 7,48 m / 24'6"
Draft	1,02 m / 3'34"

SPECIFICATIONS

Design: Camillo Garroni

Hull: Philippe Briand

20 m² / 215 sqft living space

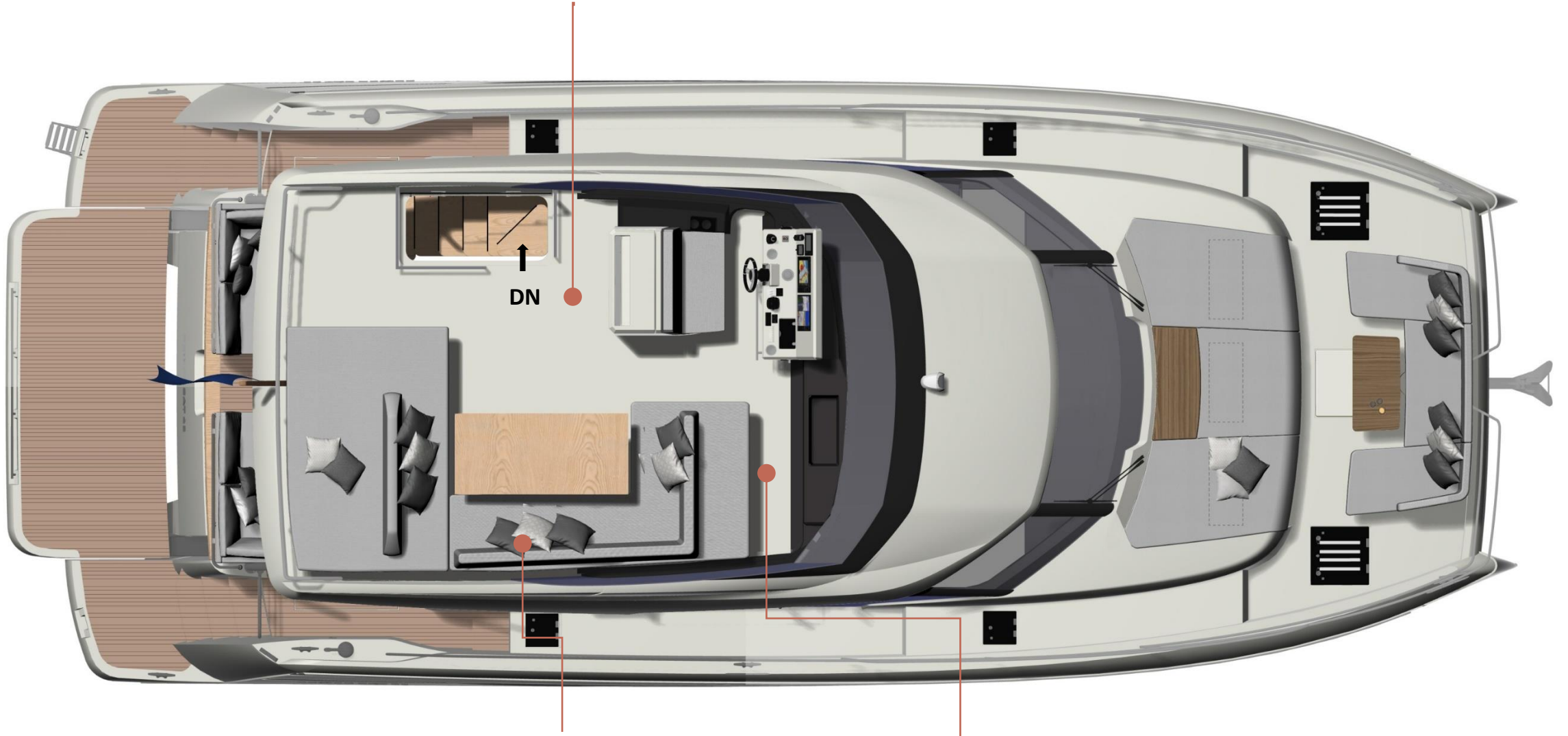

RODA free standing sofa

Optional hardtop

M48

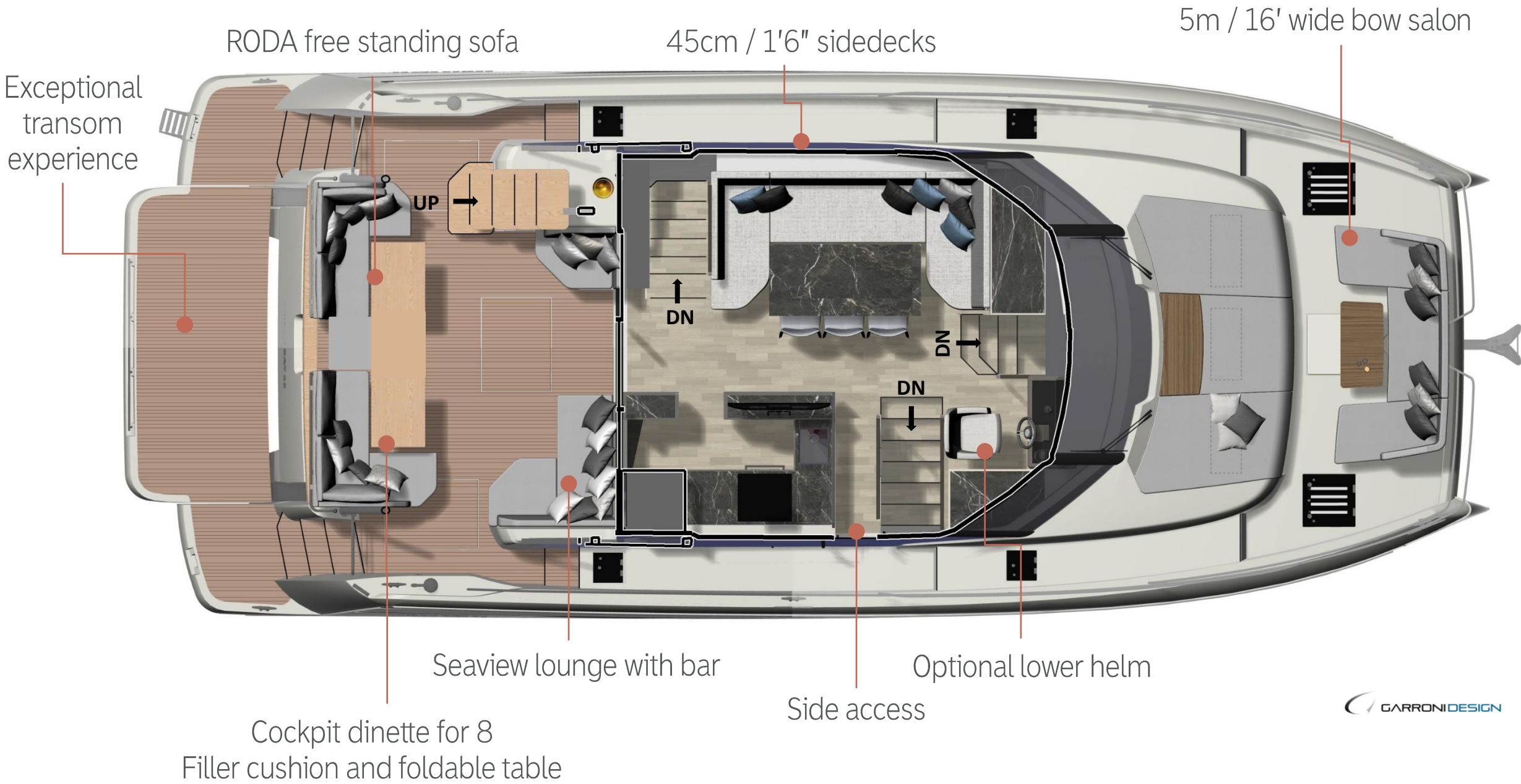



❖ Cockpit terrace and Beach Club area



Toys storage 3m³ capacity



3,50m / 11'6" tender on lifting platform



Same space as a 60' monohull







Layout: 3 cabins, 3 bathrooms

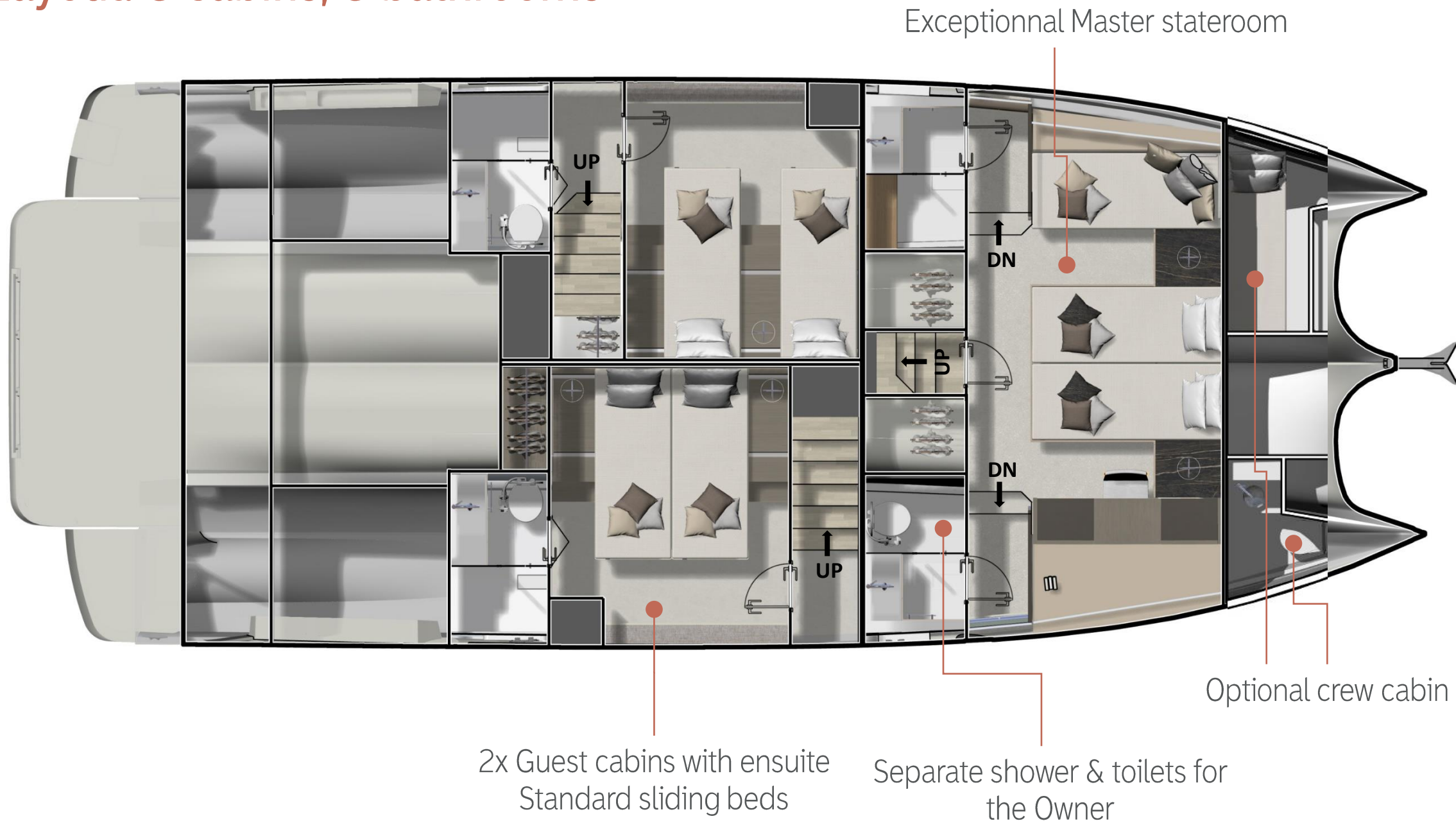

- 5m / 16' wide Owner's suite



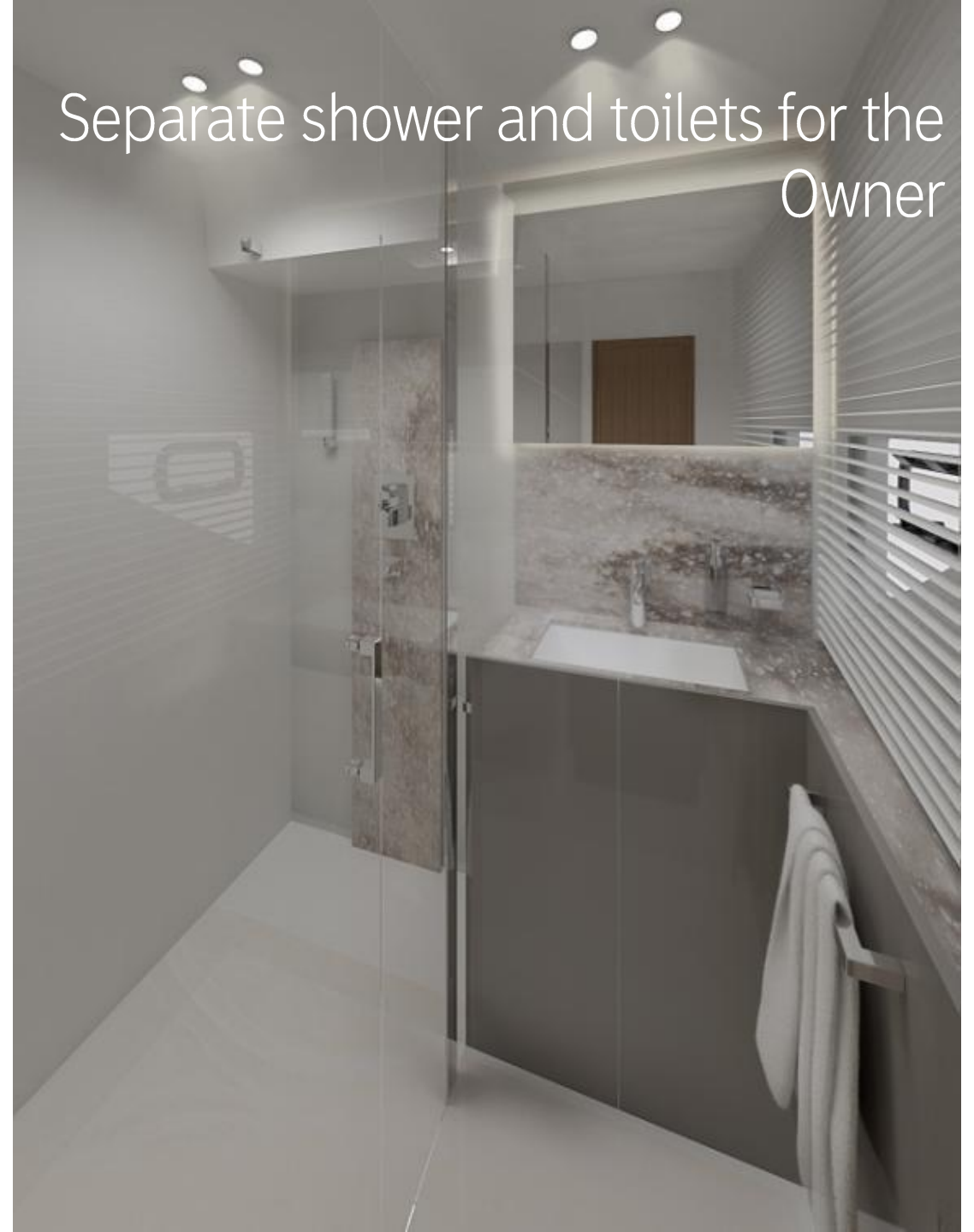

2 symmetric Guest cabins with seaview from the Bed



Optional layout: 4 cabins, 4 bathrooms

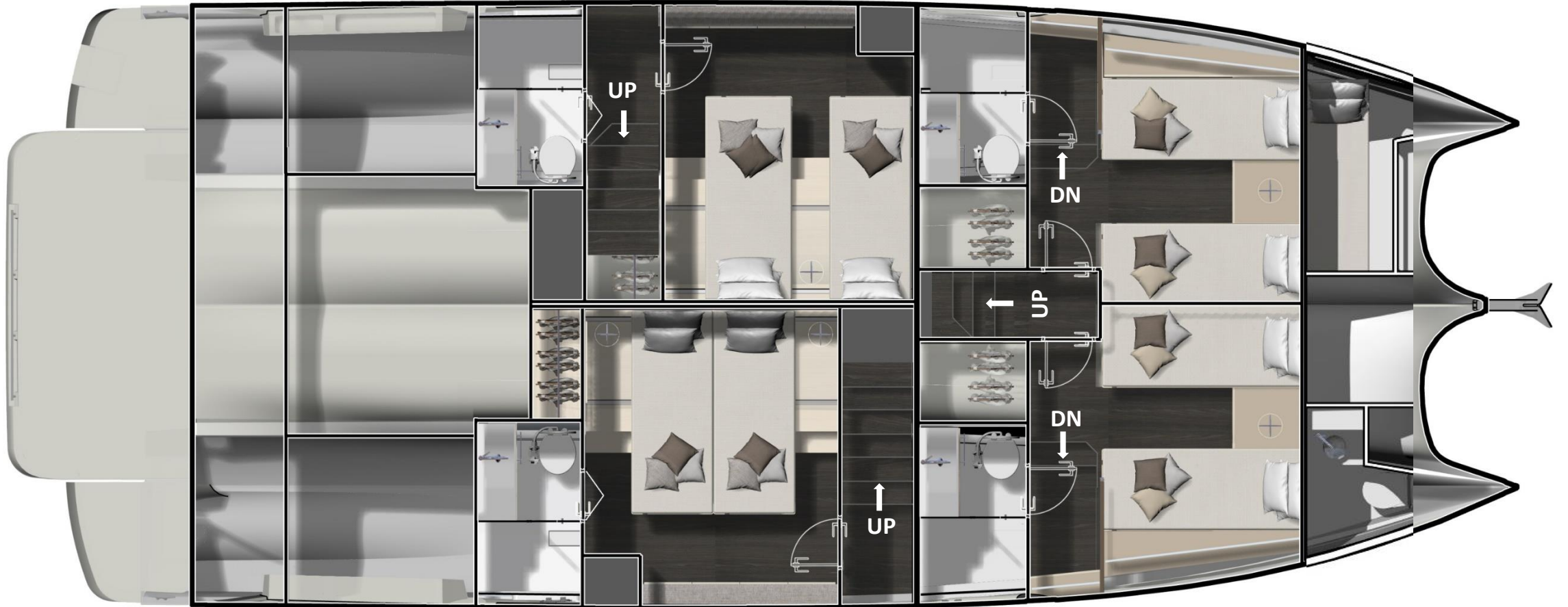

PRESTIGE luxury and quality

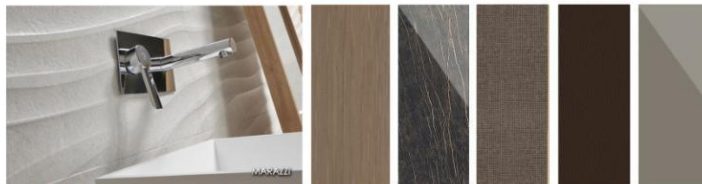

Inspirations
Owner version
Shining wood

Details
 Materials
 New ambiances

Materials

1. ALPI WOOD NOYER FILL
2. CREVIN BORA-BORA 07
3. CLEAR SURF BIANCO 8011
4. LAMINAM NOIR DESIRE LUCIDO
5. SPARKLING ZANDER ZAN-3120 MOCCA
6. CLIPSO 495 AC 4030 NUAGE
7. LAQUERED MEME COULEUR FENIX CIRGIO LONDRA 95GL
8. SPARKLING HORIZON SOREEE HOR-9943
9. BRUSHED WHITE OAK
10. LAQUERED FENIX SATINE GB 95GL
11. CORIAN HEZELNUT
12. TEAK
13. FIBERGLASS
14. MIRROR
15. CORIAN VENARO WHITE
16. MOQUETTE GRIS PRESTIGE
17. SPEEDO WHITE

GARRONDESIGN